

4200 Sliding System with thermal break

A versatile system with multiple perimetral frames and the possibility of head or perimetral sashes.

This presents a stylish option with curved or straight sashes. In its version of straight head sashes, the **GALANDAGE** 4200 Slider solution is included. It is designed to allow the possibility of an integral opening in the space to totally hide the sashes in the building's curtain wall chamber. This achieves a 100% opening surface.

The **GALANDAGE** option allows a single rail and dual rail frame allowing for balcony systems with 1, 2 & 4 hidden sashes.

It also allows for the incorporation of one sash in parallel hidden from the Tamiz solar protection system.



4200 Sliding System with thermal break

Transmittance

Uw from 1,5 (W/m²K)

Please consult typology, dimensions and glass

Acoustic insulation

Maximum glazing: 26 mm.

Maximum acoustic insulation **Rw=39 dBA**

Finishes

Possibility of dual colour

Colour powder coating (RAL, mottled and rough)

Wood effect powder coating

Anti-bacterial powder coating

Anodized

Air permeability
(EN 12207:2000): Class 3

Water tightness
(EN 12208:2000): Class 7A

Wind resistance
(EN 12210:2000): Class C5
Reference test 1,20 x 1,20 m. 2 sashes



Sections

Frame 60/65/77/80 mm.
106/126 mm. 3 rails
Sash 33 & 37 mm.

Profile thickness

Window 1,5 mm.

Polyamide strip length from 14,6 to 20 mm.

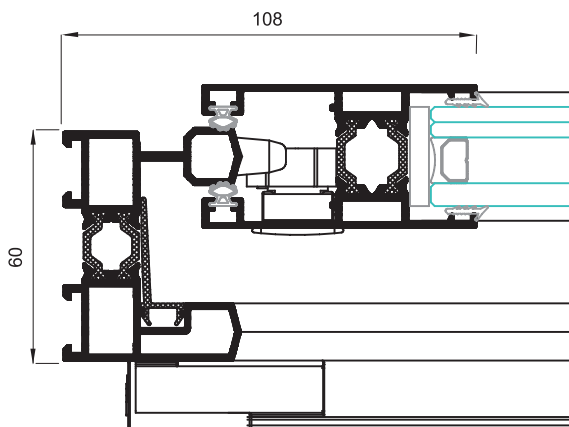

Opening possibilities

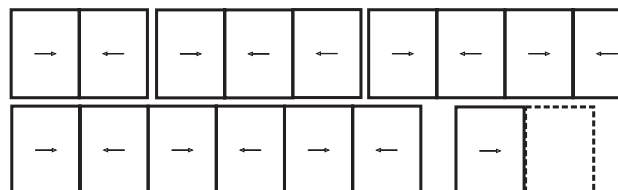

Slider of 2, 3, 4 & 6 sashes.
Possibility of 3 rails.
Possibility of single or dual rail galandage in 1, 2 & 4 sashes.

Maximum dimensions

Width (L) = 4.400 mm.
Height (H) = 2.600 mm.
2 sashes window

Maximum weight/sash

100 Kg. (Perimetral sash)
200 Kg. (Head sash)

Please consult regarding maximum weight and dimensions for other opening types